



ENERGY & LIGHTING

DIESEL GENERATORS



TEC30D, TEC40D

USER'S MANUAL

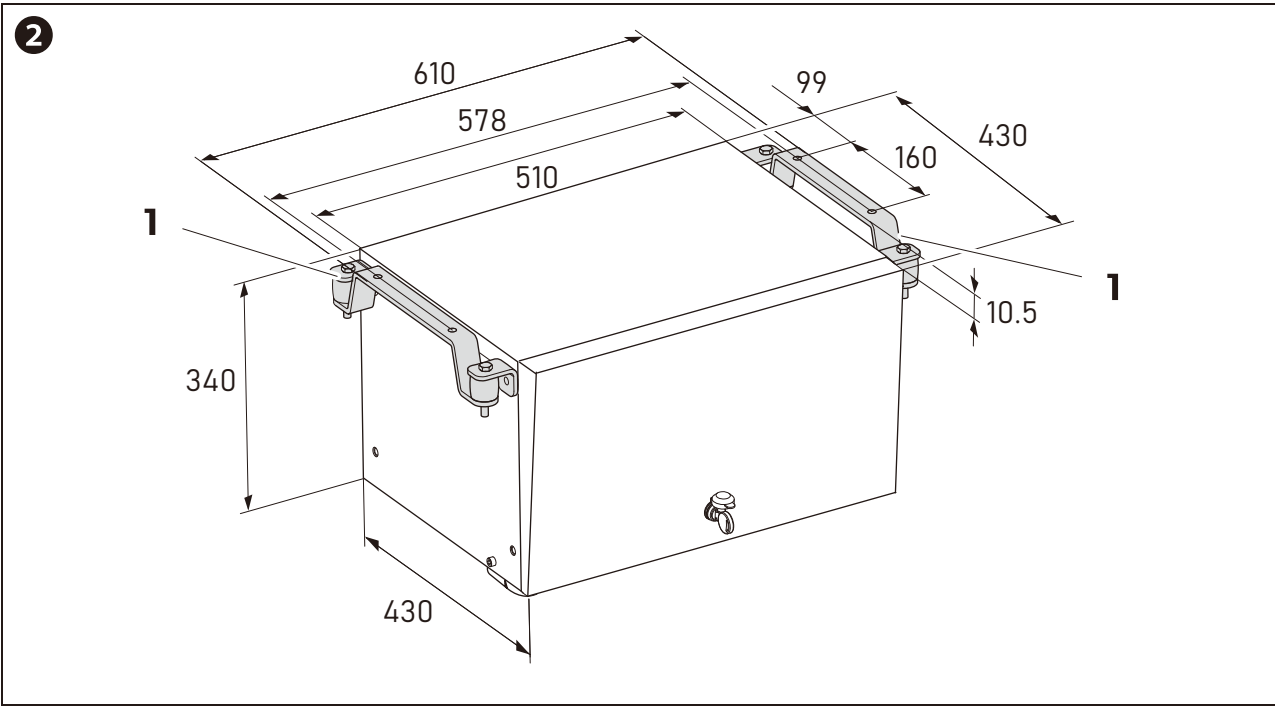
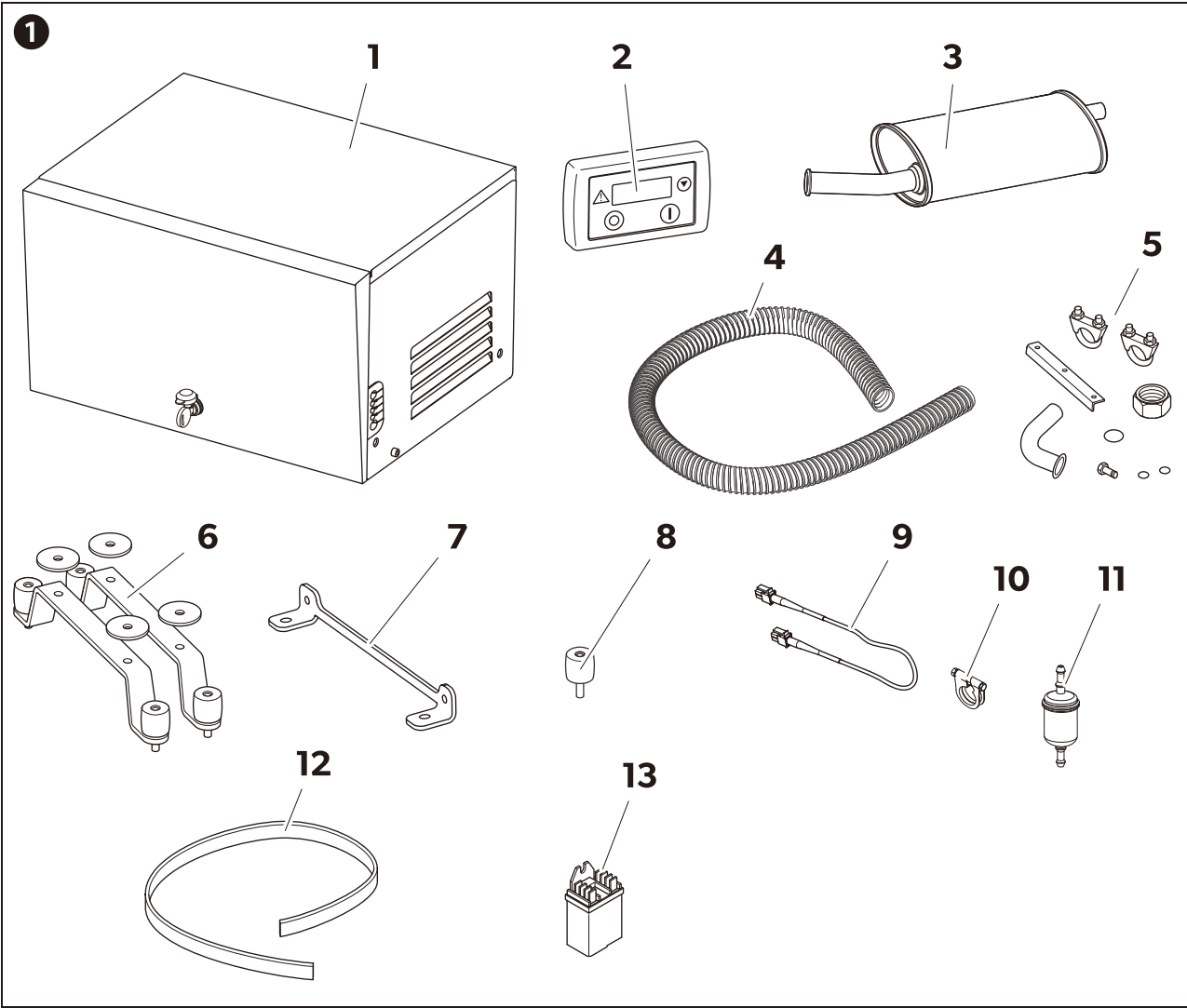

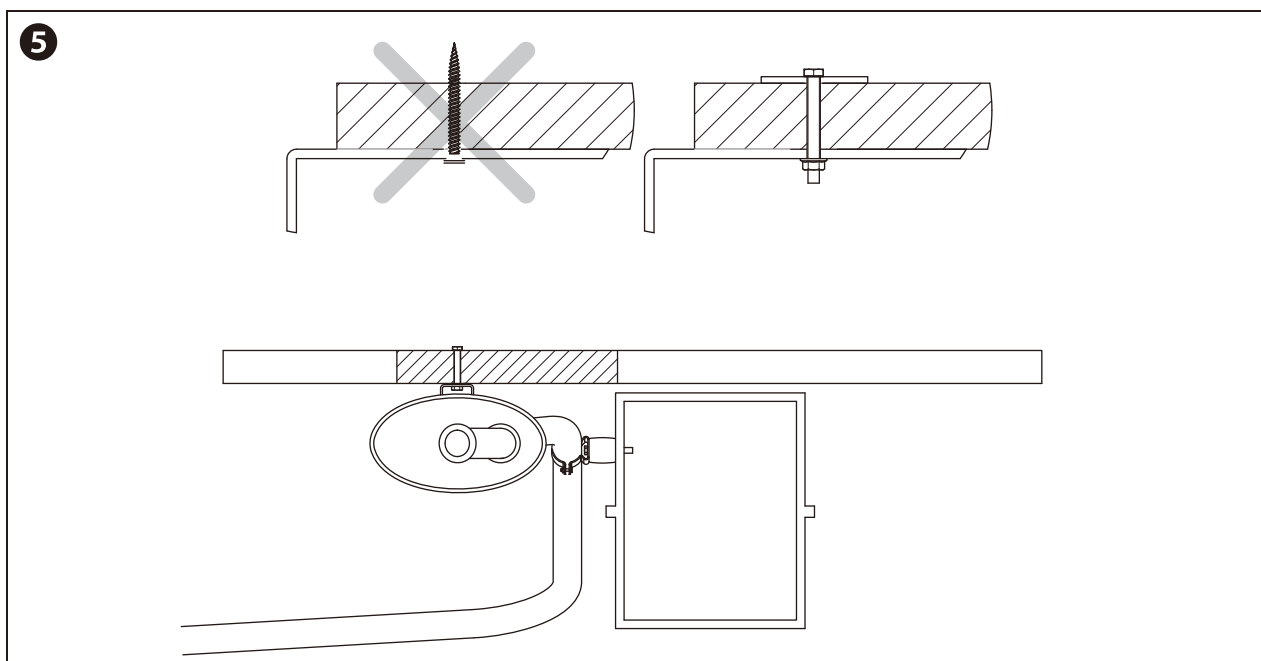
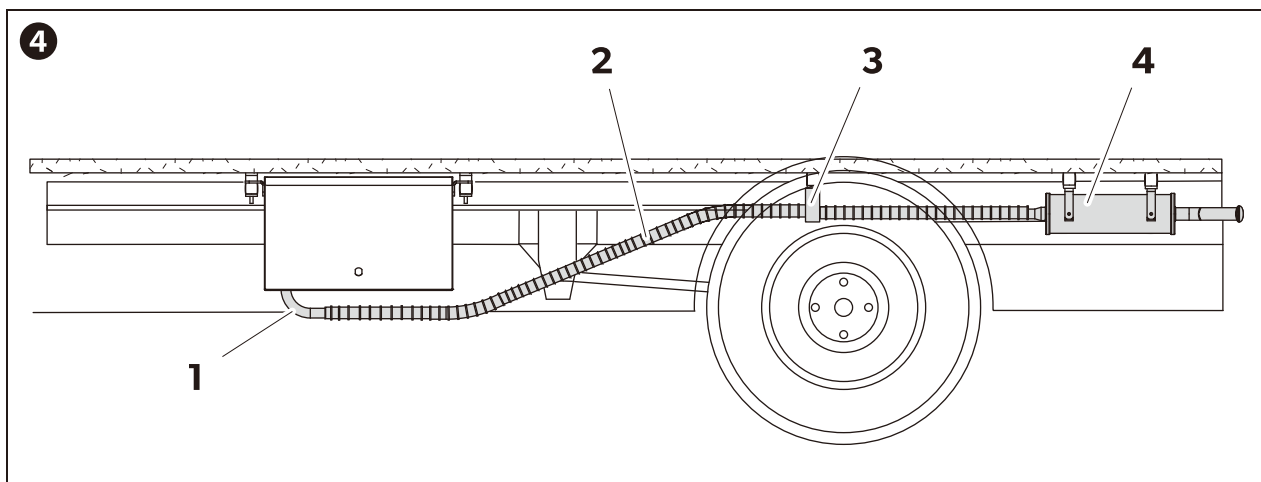
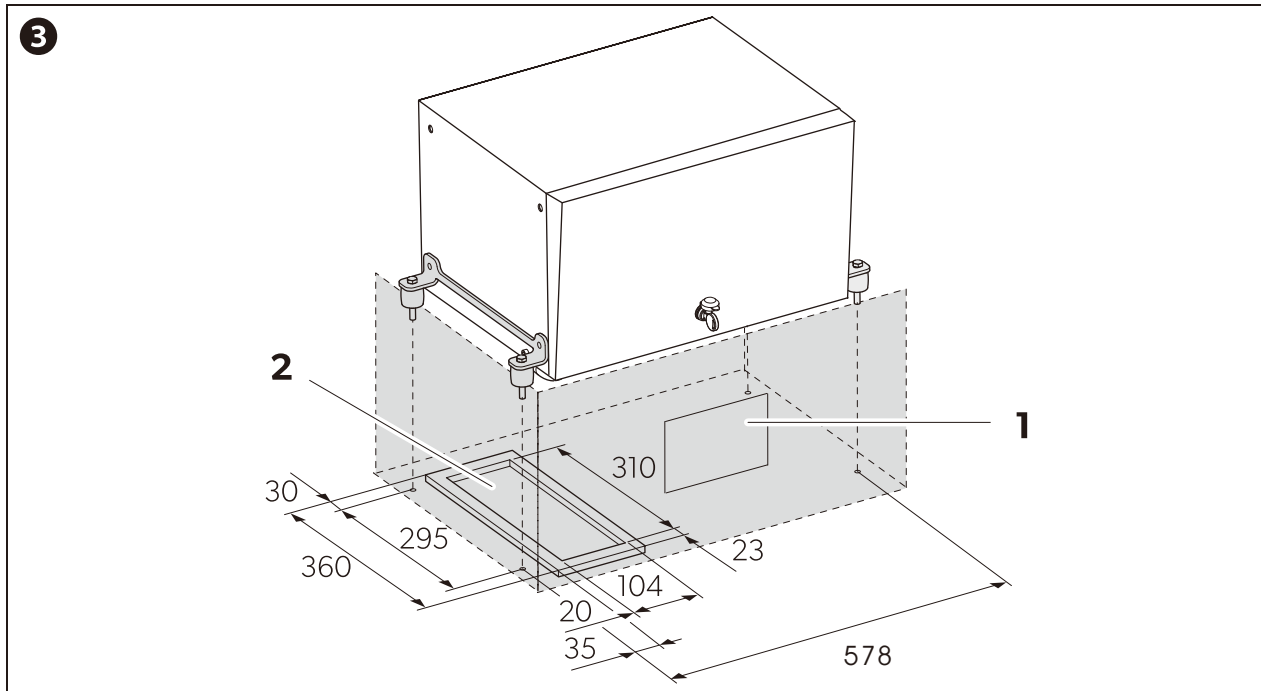

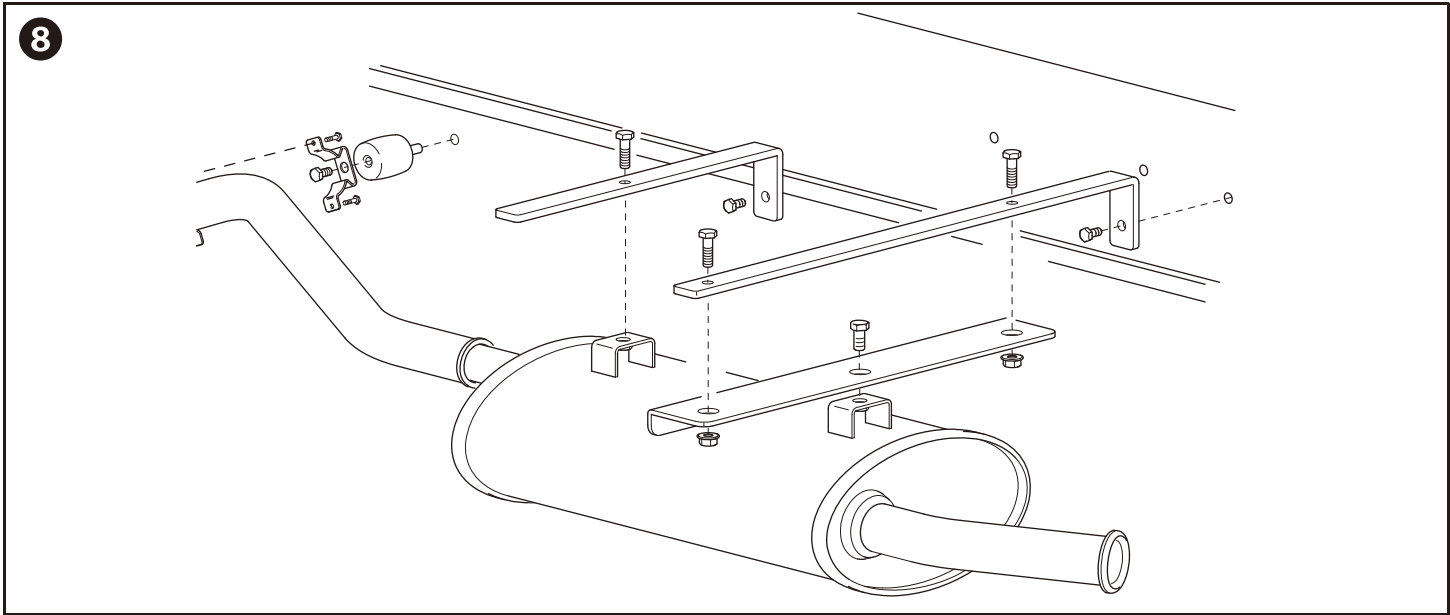
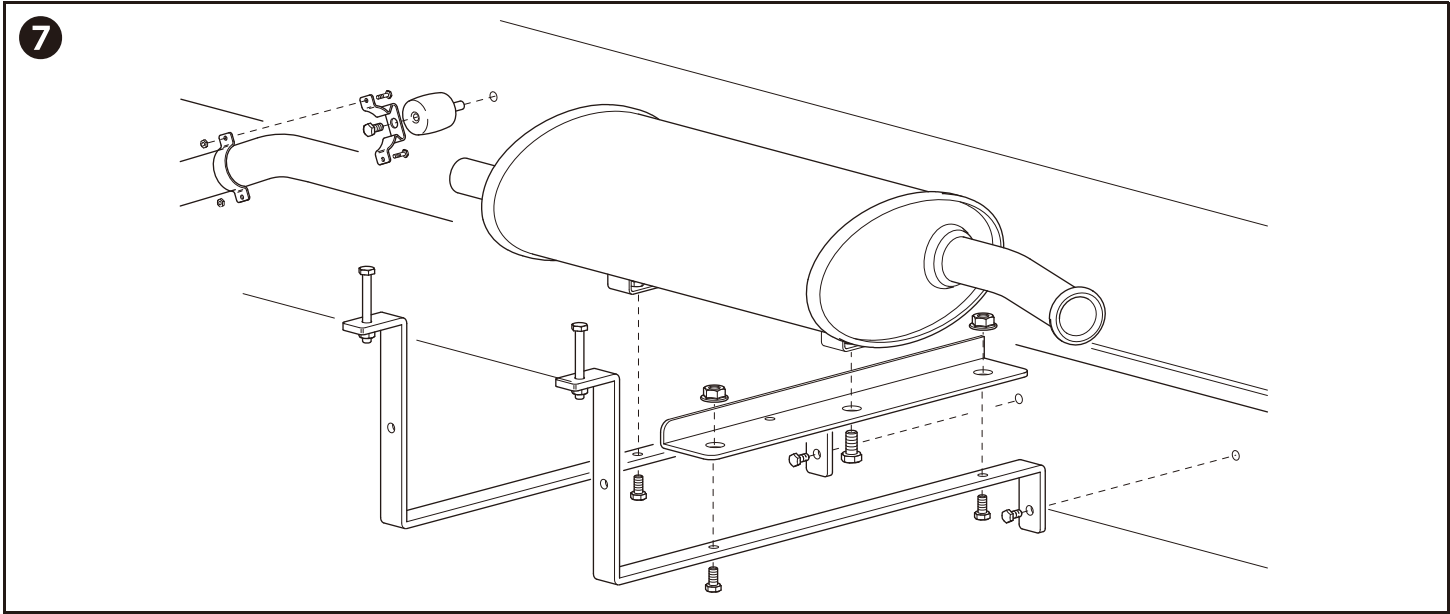
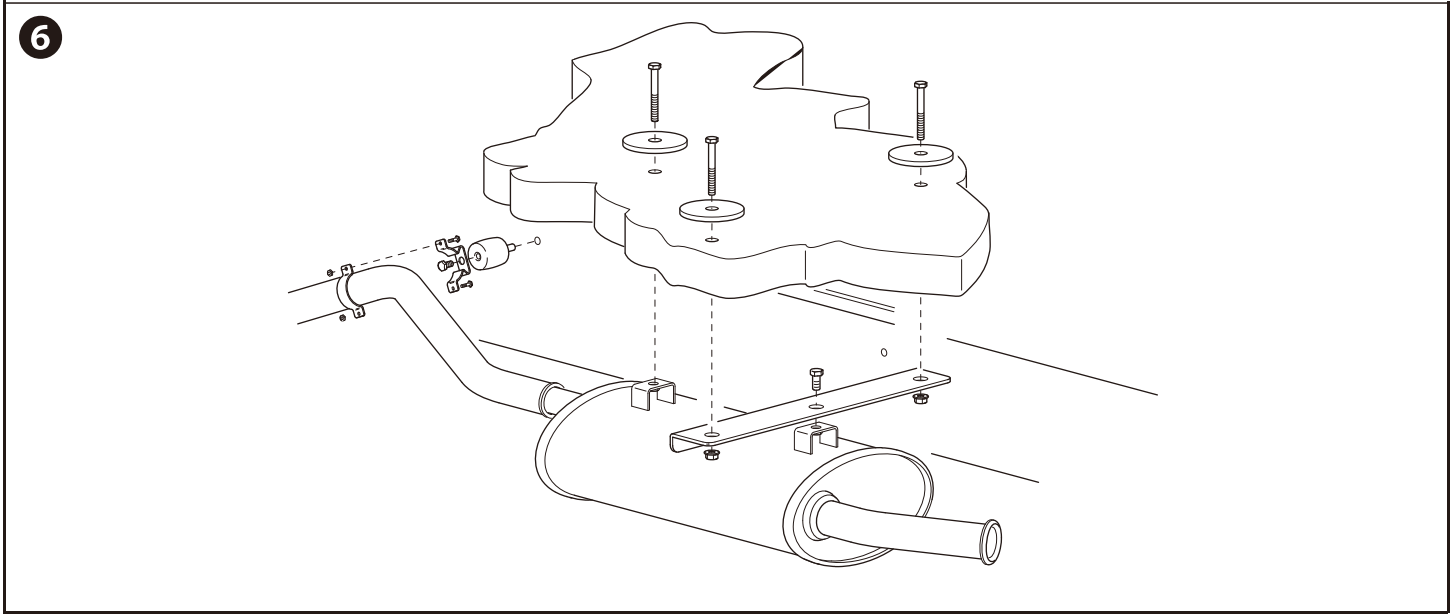

9

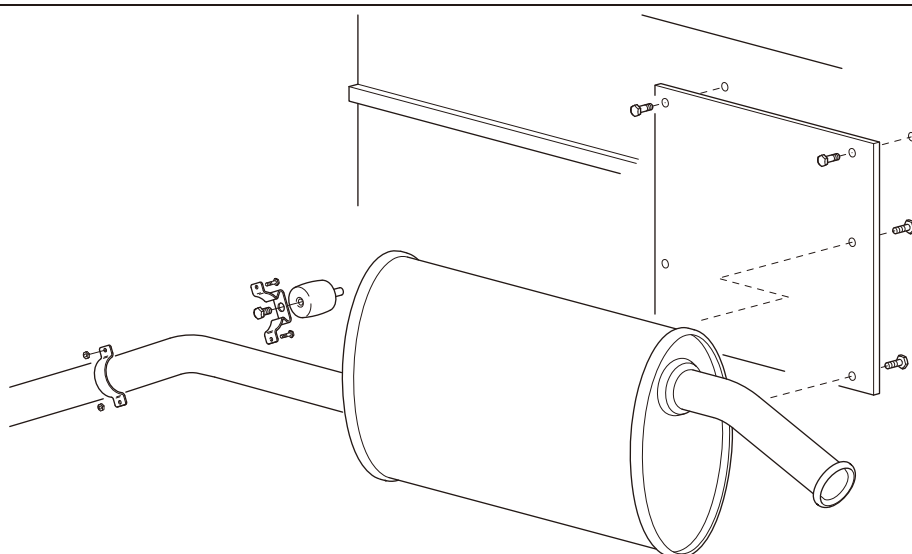

10

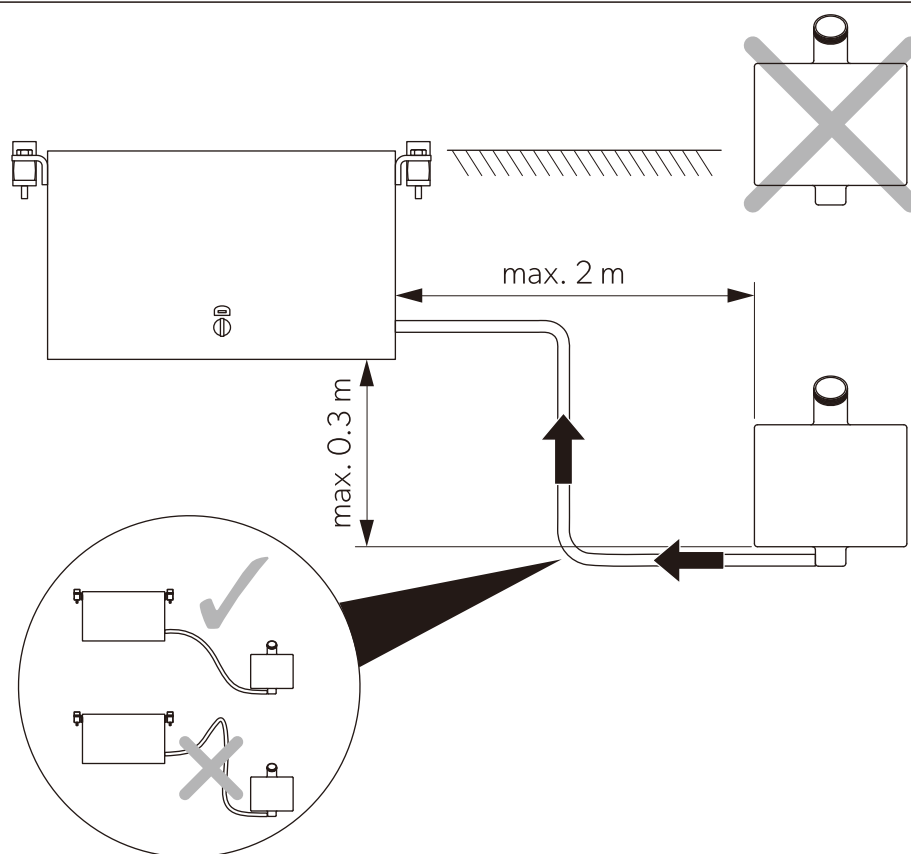

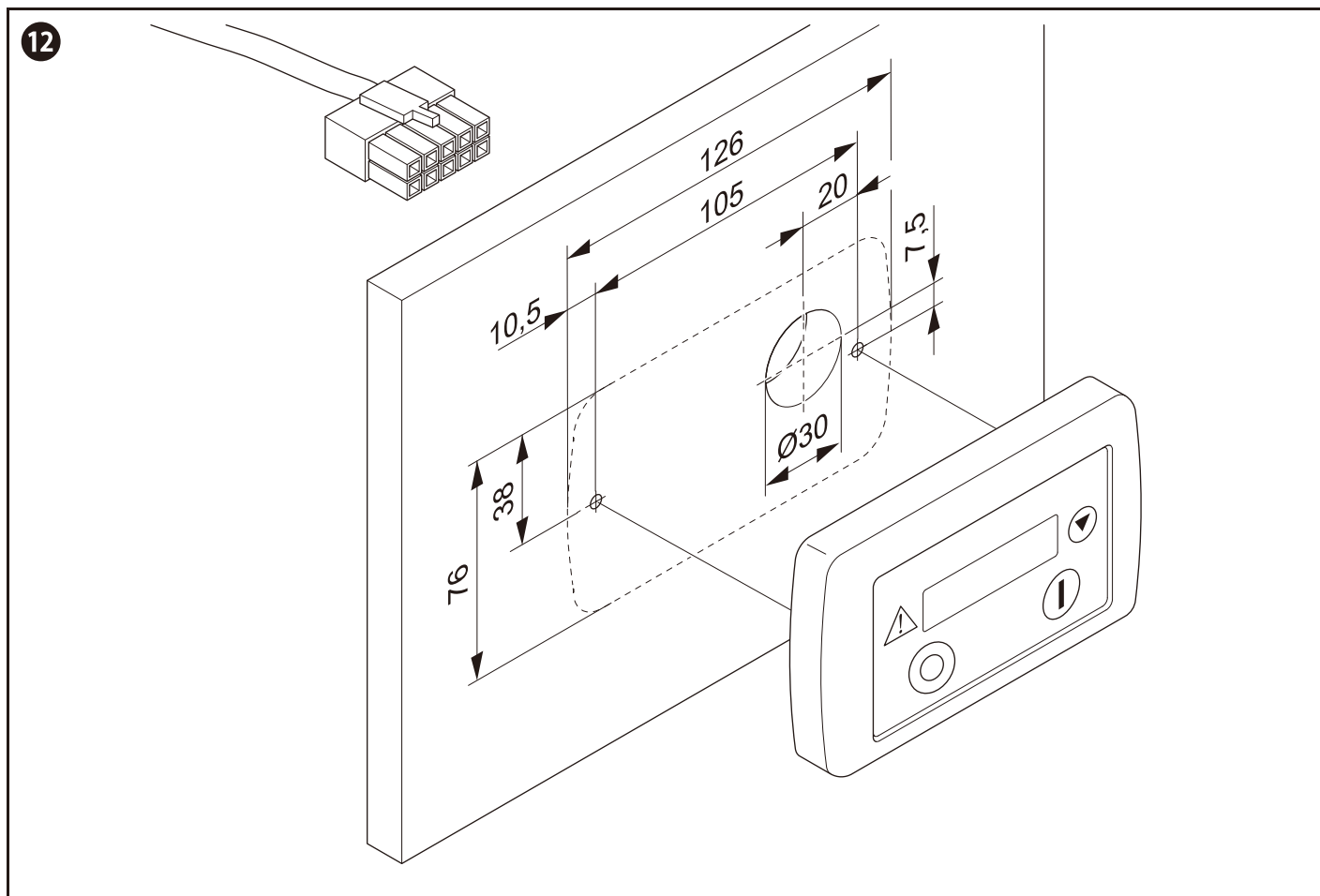

13

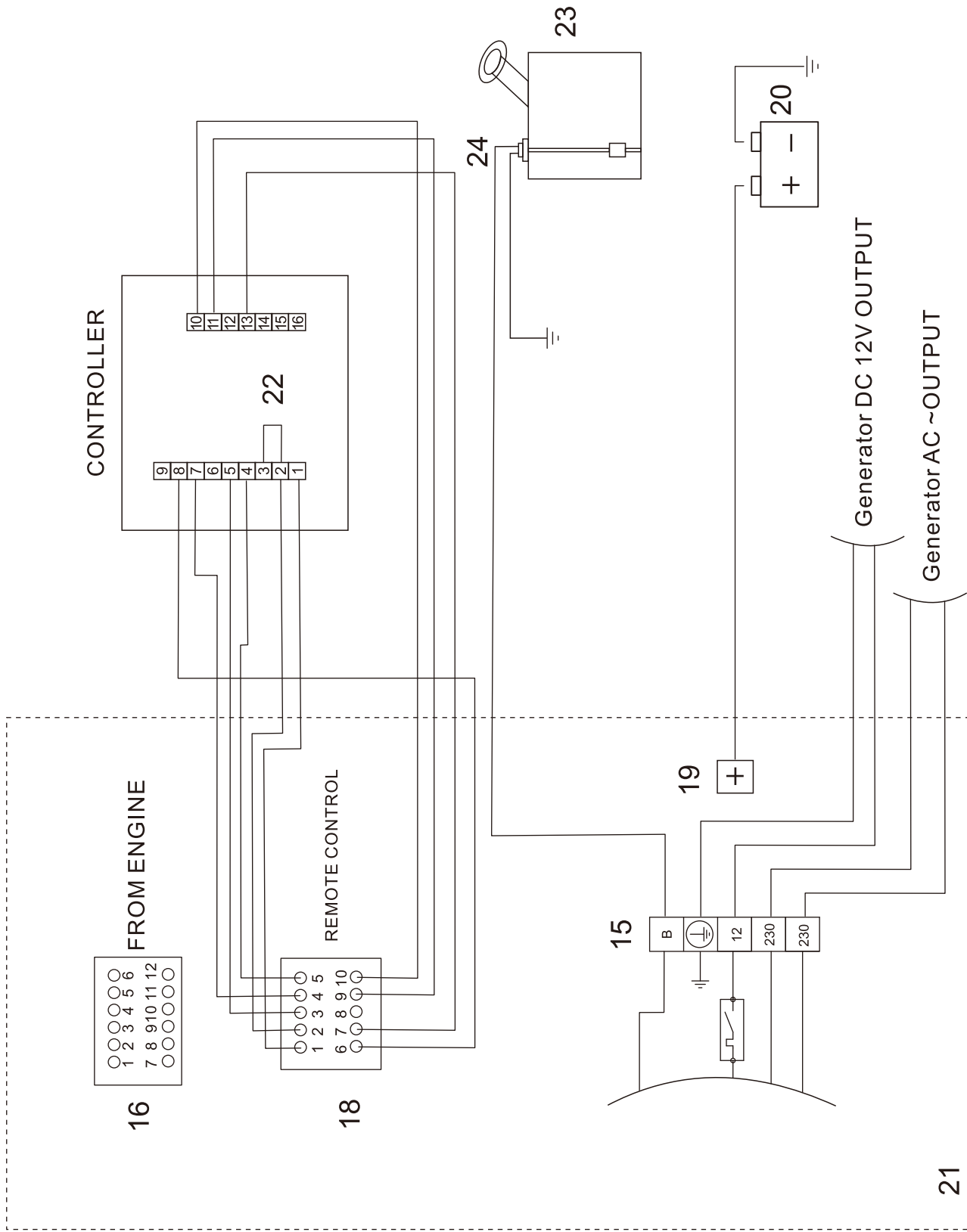

14

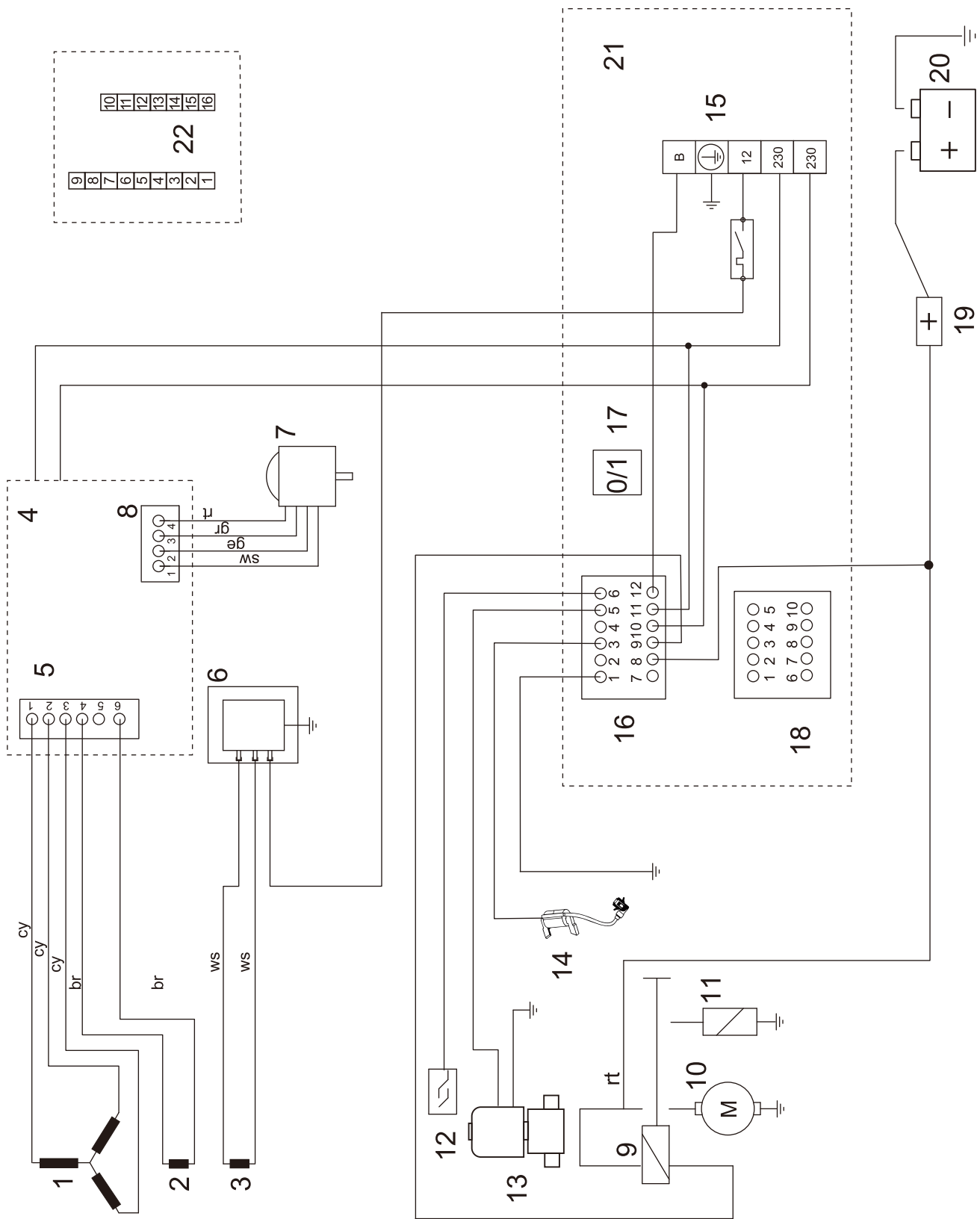

15

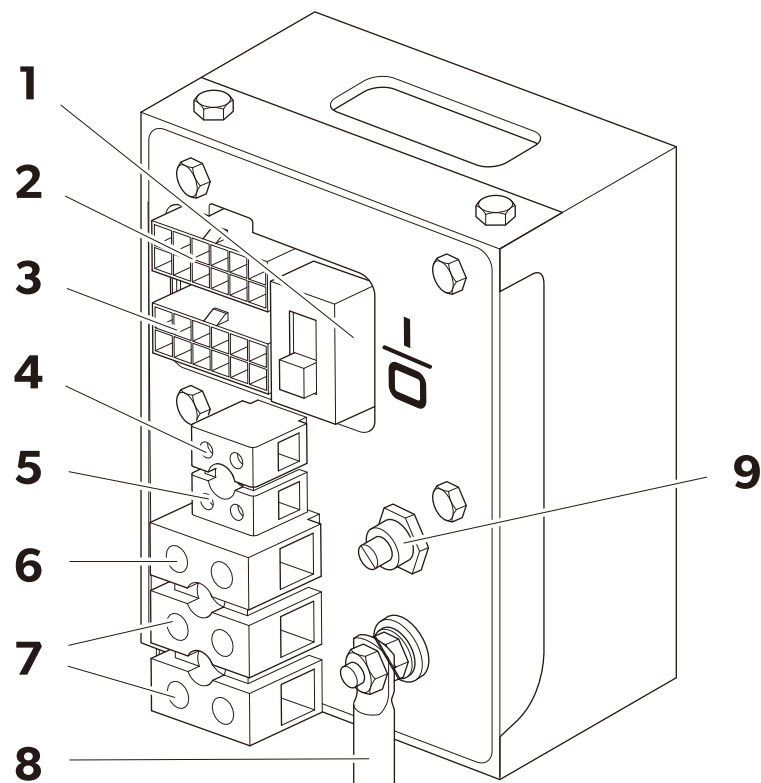

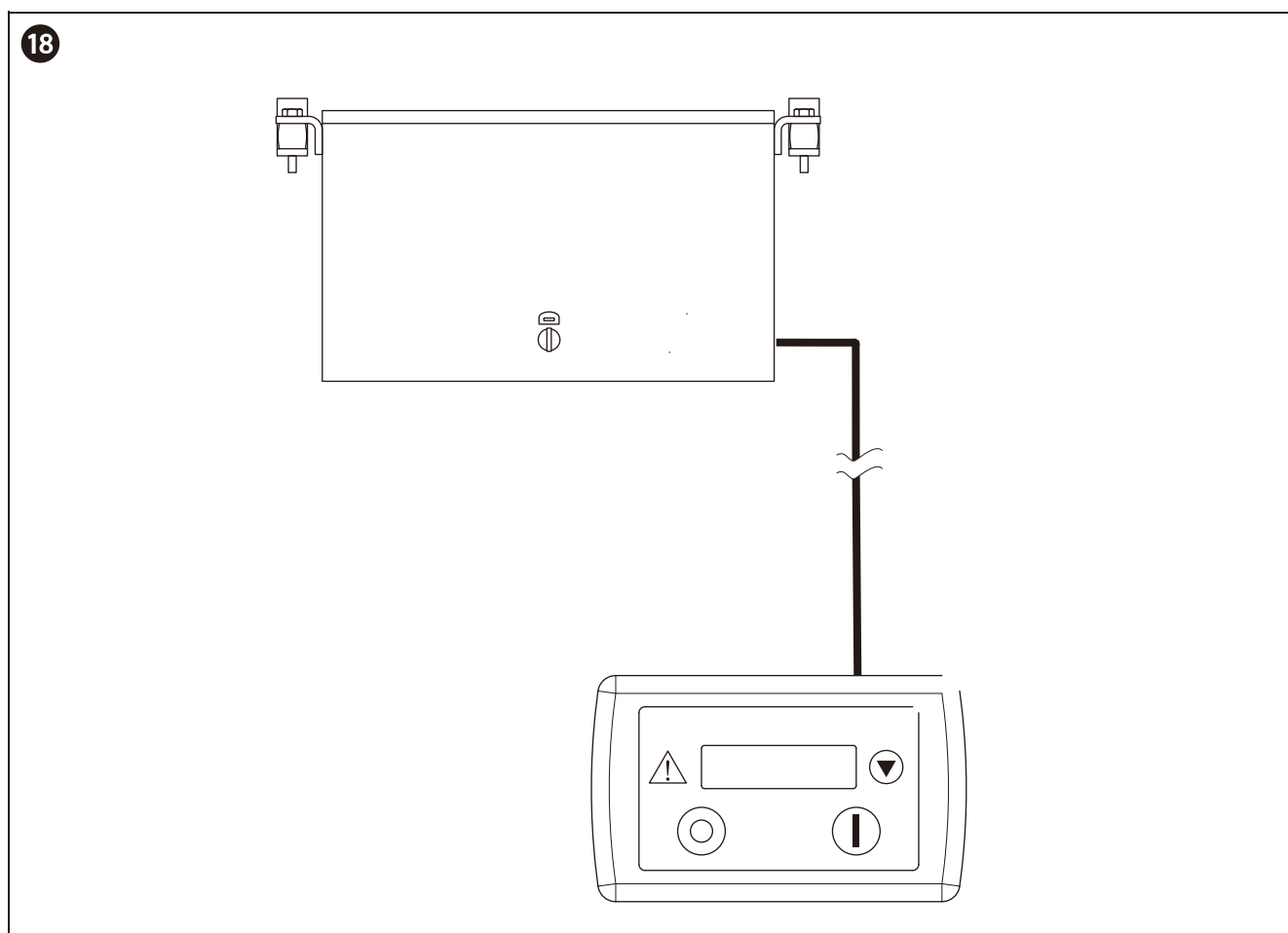
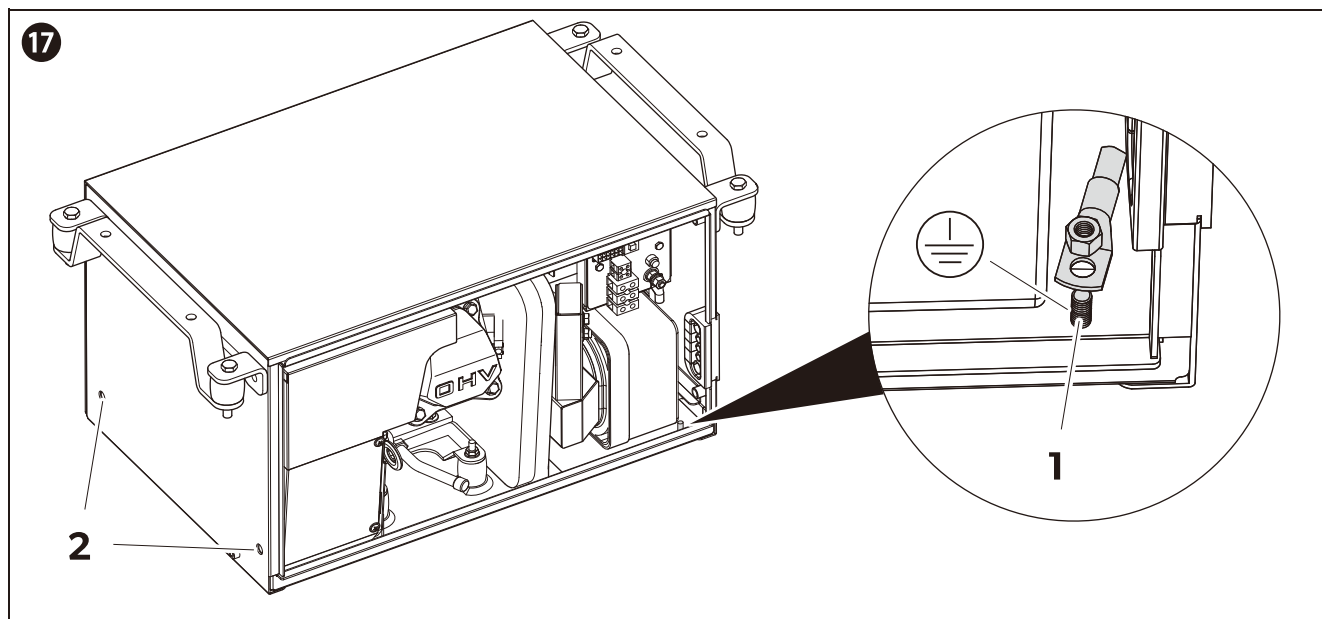

19

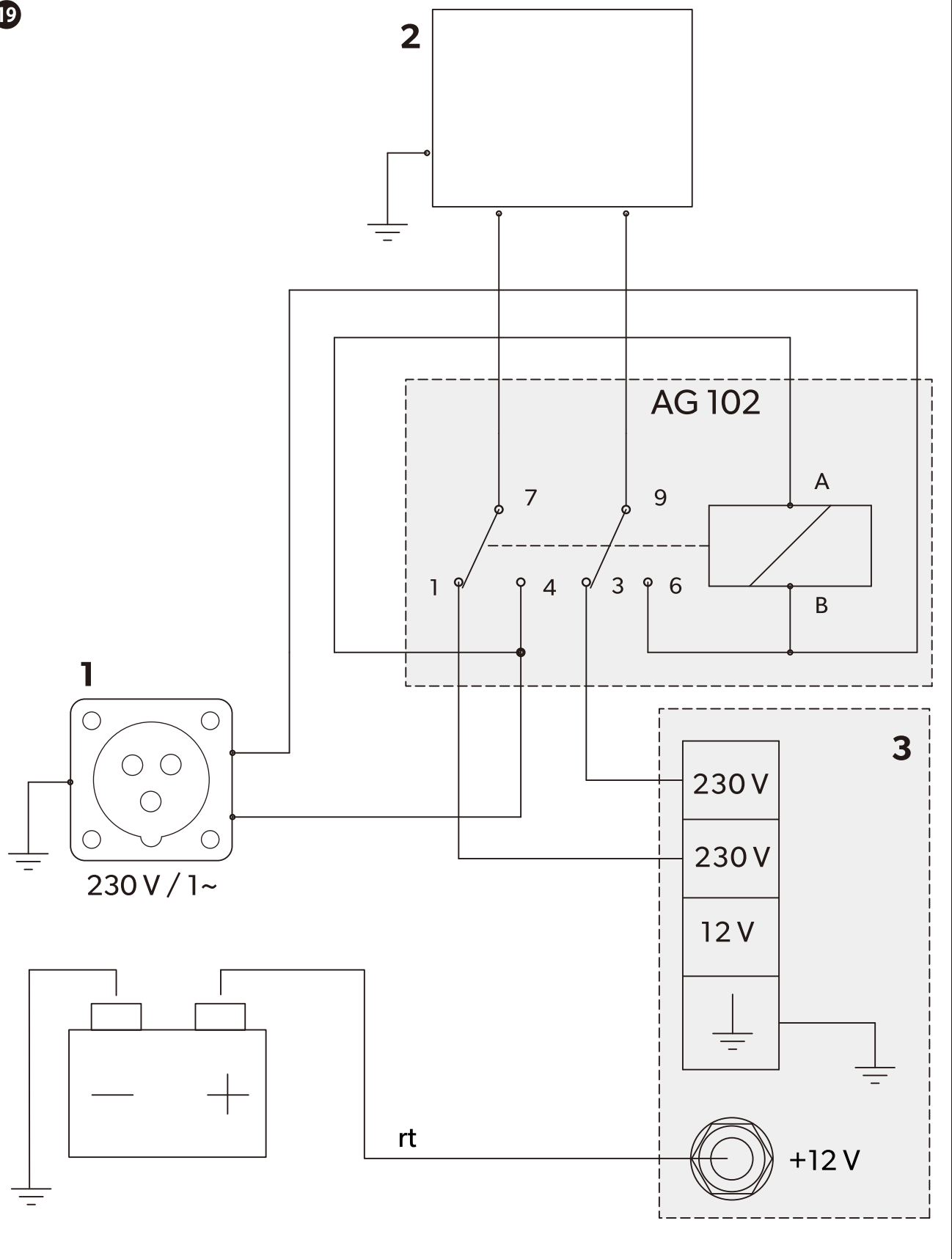

Please read this instruction manual carefully before installation and first use, and store it in a safe place. If you pass on the product to another person, hand over this instruction manual along with it.

Table of contents

1	Explanation of symbols	16
2	Safety and installation instructions	16
3	Target group for this manual.	18
4	Scope of delivery	19
5	Accessories	19
6	Intended use	20
7	Labels.	20
8	Technical description	20
9	Installation	21
10	Connecting the electrical power to the generator	24
11	Disposal.	32
12	Technical data	32

1 Explanation of symbols

**DANGER!**

Safety instruction: Failure to observe this instruction will cause fatal or serious injury.

**WARNING!**

Safety instruction: Failure to observe this instruction can cause fatal or serious injury.

**CAUTION!**

Safety instruction: Failure to observe this instruction can lead to injury.

**NOTICE!**

Failure to observe this instruction can cause material damage and impair the function of the product.

**NOTE**

Supplementary information for operating the product.

2 Safety and installation instructions

Please observe the prescribed safety instructions and stipulations from the vehicle manufacturer and service workshops.

The manufacturer accepts no liability for damage in the following cases:

- Faulty assembly or connection
- Damage to the product resulting from mechanical influences and excess voltage
- Alterations to the product without express permission from the manufacturer
- Use for purposes other than those described in the operating manual

Note the following basic safety information when using electrical devices to protect against:

- Electric shock
- Fire hazards
- Injury

2.1 Using the device



WARNING!

- Installing and repairing the device may only be carried out by qualified personnel who are familiar with the risks involved and the relevant regulations. Inadequate repairs may cause serious hazards. For repair service, please contact the service centre in your country (addresses on the back page).
- **Electrical devices are not toys**
Keep electrical devices out of reach of children or infirm persons. Do not allow them to use electrical devices without supervision.
- People (including children) whose physical, sensory or mental capacities prevent them from using this device safely may not be allowed to operate it without the supervision of a responsible adult.
- Exhaust fumes contain carbon monoxide which is a highly toxic, odourless and colourless gas. Do not inhale any exhaust fumes. Do not leave the generator motor running in a closed garage or in a room without windows.



CAUTION!

- **Fire hazards**
Do **not** install the generator in a box or room without any openings, but in well-ventilated spaces instead.
- Only operate the generator if you are certain that the housing and the cables are undamaged.
- Install the generator on a stable surface.
- Do not tilt the generator more than 20° from the vertical position.



NOTICE!

- Only use the device as intended.
- The generator is not suitable for use in water vessels.
- Do not make any alterations or conversions to the device.
- If a welding operation has been done on the vehicle disconnect all generator cables, otherwise the electronics may be damaged.

2.2 Handling electrical cables



WARNING!

- The electrical power supply may only be connected by a qualified electrician (e.g. according to VDE 0100, Part 721 in Germany).



CAUTION!

- Attach and lay the cables so that they cannot be tripped over or damaged.



NOTICE!

- Use cable ducts to lay cables through walls with sharp edges.
- Do not lay loose or bent cables next to electrically conductive materials (metal).
- Do not pull on the cables.

3 Target group for this manual

The instructions in this manual are intended for qualified personnel at workshops who are familiar with the guidelines and safety precautions to be applied.

4 Scope of delivery

No. in fig. 1 , page 3	Number	Description
1	1	Generator
2	1	Remote control
3	1	Silencer
4	1	Exhaust pipe, 2 m
5	1 set	Mounting brackets for silencer
6	1 set	Retaining brackets for external installation
7	2	Holders for internal installation
8	4	Spacers
9	1	Extension cable for remote control, 5 m
10	2	Hose clamp
11	1	Fuel filter

5 Accessories

Available as accessories (not included in the scope of delivery):

Part designation	Item number
AG 100, tank 22 l, stainless steel	9102900011
AG 125, flexible metal pipe for extending exhaust pipe, 2m	9102900138
AG 113, external silencer	9102900015

Intended use
